

Lightweight, compact and reliable safety shut-off valve that uses a solenoid valve drive method.

Medium pressure gas cutoff valve (quick open) VNM Series

- NC (Open when energized)
- City gas/LPG
- Port size: 25A (JIS flange)

RoHS

Features

- Equipped with a robust dedicated terminal box with JIS standard conduit thread, making electrical wiring easy too.
- The DC driven actuator with rectifier has eliminated noise and coil burnout for safety.
- Equipped with a pressure switch/pressure gage mountable connection port on the body
- With power indicator lamp

Flow characteristics

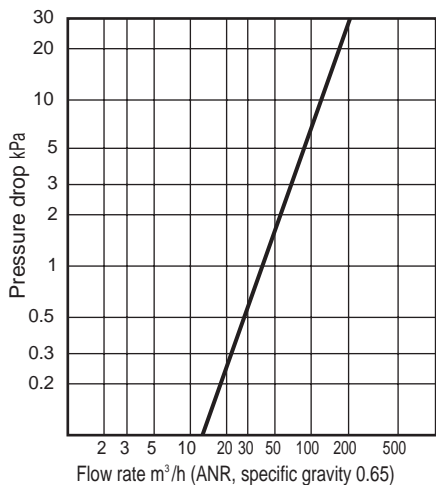

Specifications

Item	VNM-25
Working fluid	City gas/LPG
Working pressureMPa	0 to 0.3
Flow rate ^{Specific gravity of city gas 0.65} m ³ /h(ANR)	19
Cv	12.8
Rated voltage V	100 AC ±10% 200 AC ±10%
Frequency Hz	Common to 50 and 60
Power consumption (apparent power)VA	82
Ambient temperature°C	-20 to +60 (no freezing)
Opening time s	0.5 or less
Closing time s	1.0 or less
Frequency cycles/min.	30 or less
Mounting orientation	Vertical direction with the coil up or horizontal direction with the coil horizontal
Connection	Flange(JIS10KRF)
Port size	25 A
Weight kg	7.7
Proof pressure MPa	0.5
Degree of protection	IPX4

Reference: conversion coefficient

Converted flow rate = (flow rate in table) x (coefficient)

Gas	City gas (13A)	Propane	Butane
Specific gravity (air = 1)	0.65	1.6	2.0
Coefficient	1.0	0.63	0.57

How to order

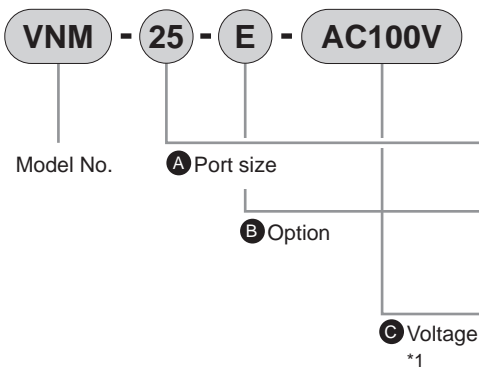

Code	Description	
A Port size		
25	JIS flange 25A	
B Option		
Blank	Standard	
E	With operation confirmation micro switch	
C Voltage		
AC100V	Standard	100 VAC 50/60Hz
AC200V		200 VAC 50/60Hz
AC110V	Option	110 VAC 50/60Hz
AC220V		220 VAC 50/60Hz
DC24V		24 VDC

*1: For voltages other than above, contact CKD.

Internal structure and parts list

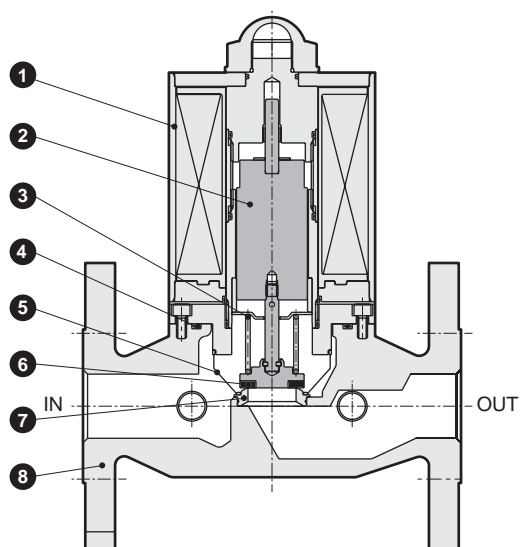

Cannot be disassembled

No.	Part name	Material
1	Bonnet	Steel
2	Plunger	Stainless steel
3	Spring	Stainless steel wire
4	O-ring	Fluoro rubber
5	Filter	Stainless steel wire
6	Valve disc	Urethane rubber
7	Valve seat	Stainless steel
8	Body	Ductile cast iron

Dimensions

● VNM-25

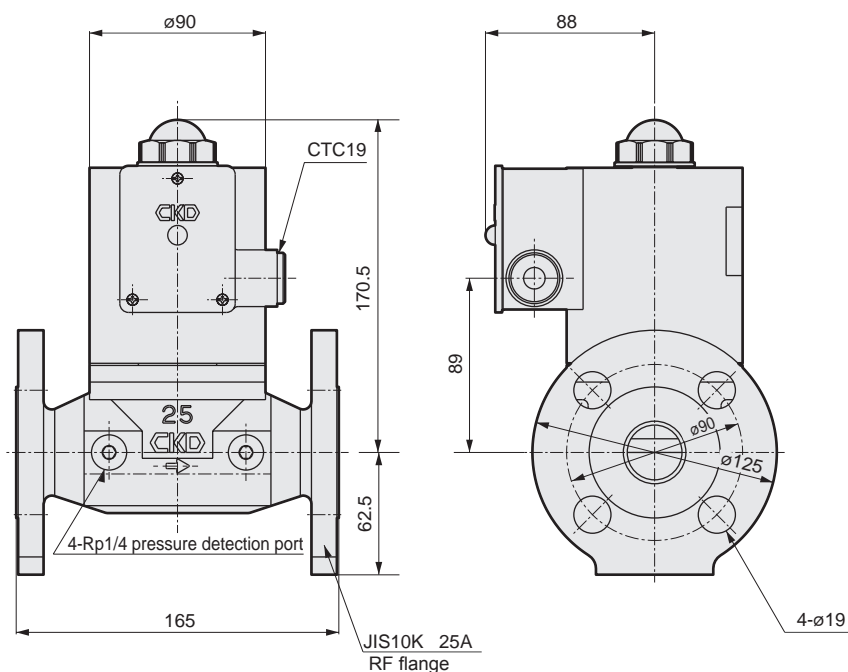

EXA
FWD
HNB/G
USB/G
FAB/G
FGB/G
FVB
FWB/G
FHB
FLB
AB
AG
AP/ AD
APK/ ADK
DryAir
EX- XPLNprf
XPLNprf
HVB/ HVL
S [◇] B/ NAB
LAD/ NAD
Water- Rela
NP/NAP/ NVP
SNP
CHB/G
MXB/G
Other valves
SWD/ MWD
DustColl
CVE/ CVSE
CCH/ CPE/D
LifeSci
Gas- Combus
Auto- Water
Outdoor
SpecFld
Custom
Ending